

Hartlepool Innovation Centre.



Your business deserves a great place to call home. With serviced offices and industrial units in a range of sizes, our premises are high quality and great value.

A coastal beacon.

Think of Hartlepool and heavy industry may well come to mind. These days, though, this proud town has many more strings to its bow.

The chemicals industry is booming. Tourism is worth millions of pounds a year. Companies big and small are setting up shop.

Hartlepool Innovation Centre, our top-spec workspace at Queens Meadow Business Park, is playing its part in all this regeneration.

In a handy spot just off the main road towards Billingham, Middlesbrough and Stockton-on-Tees, it offers high-quality office spaces and industrial units for both new and growing businesses.

There's even a tenants' gym and a chill-out room if you need a change of pace, too.

In short, it offers everything your business needs.



Designed for growth.

Built for small and medium-sized businesses, The Innovation Centre takes care of the details so you can concentrate on the things that matter.



A wide range of units available on easy in, easy out terms.



Modern facilities including a gym complex.



Stay fast, stay connected with high-speed broadband.



Be safe and secure with CCTV surveillance, alarm systems and security key-holders.



Great transport and road links as well as free on-site parking.



Need to be open all hours? 24-hour access means you can work when you need to.

Great location. Great facilities.

Want to be connected? Direct road links give you easy access to Hartlepool town centre, Billingham, Middlesbrough and Stockton-on-Tees. Better yet, Hartlepool's seaside location means coastal and maritime businesses are never far from water.

You can think globally, too, with Teesside International Airport on your doorstep.

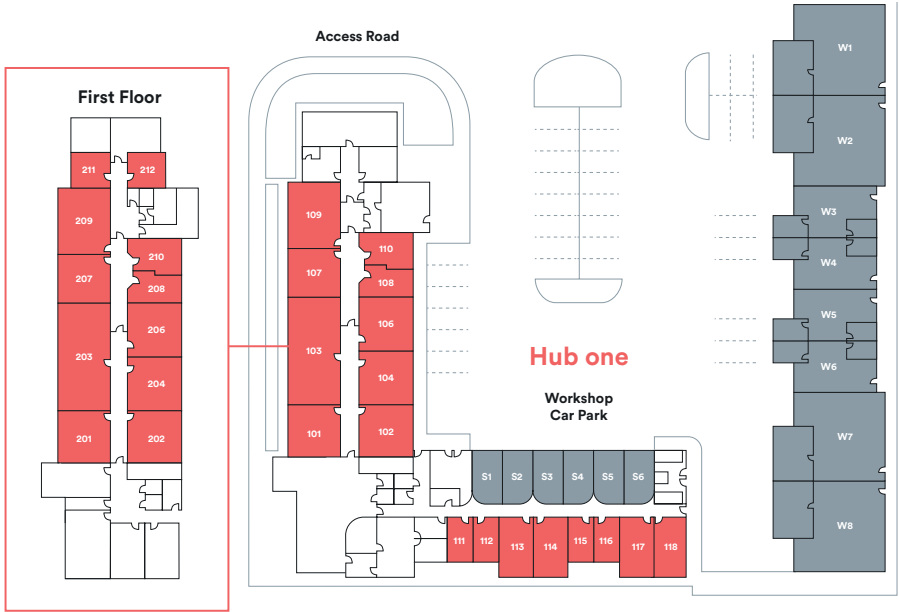

Hub two

Second Floor

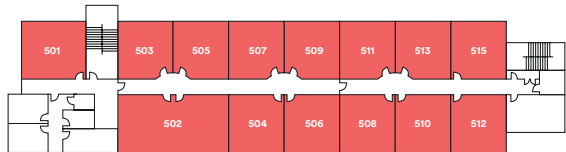

First Floor



Ground Floor

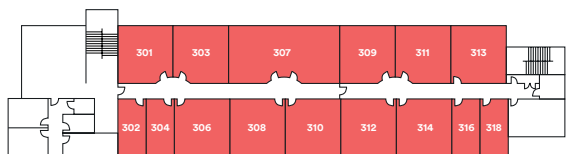

Office units to let – Hub one

Ground floor offices					
Unit	Sq ft	Seats	Unit	Sq ft	Seats
101	400	6	111	150	2
102	400	6	112	150	2
103	809	12	113	250	4
104	389	6	114	250	4
106	389	6	115	150	2
107	400	6	116	150	2
108	239	4	117	250	4
109	488	8	118	250	4
110	239	4			

First floor offices					
Unit	Sq ft	Seats	Unit	Sq ft	Seats
201	400	6	208	218	3
202	400	6	209	488	8
203	809	12	210	218	3
204	389	6	211	172	3
206	389	6	212	172	3
207	400	6			

Workshop units to let – Hub one

Small workshops			
Unit	Sq ft	Unit	Sq ft
S1	210	S4	210
S2	210	S5	210
S3	210	S6	210

Workshops			
Unit	Sq ft	Unit	Sq ft
W1	1,200	W5	600
W2	1,200	W6	600
W3	600	W7	1,200
W4	600	W8	1,200

Office units to let – Hub two

Ground floor offices					
Unit	Sq ft	Seats	Unit	Sq ft	Seats
301	409	6	310	427	7
302	206	3	311	407	6
303	409	6	312	428	7
304	209	3	313	411	7
306	427	7	314	426	7
307	823	13	316	212	3
308	436	7	318	205	3
309	407	6			

First floor offices					
Unit	Sq ft	Seats	Unit	Sq ft	Seats
401	495	8	410	428	6
402	208	3	411	473	7
403	408	6	412	428	6
404	209	3	413	473	7
405	473	7	414	427	7
406	427	7	415	414	6
407	473	7	416	209	3
408	428	7	418	210	3
409	408	6			

Second floor offices					
Unit	Sq ft	Seats	Unit	Sq ft	Seats
501	495	8	508	428	7
502	1,014	16	509	409	6
503	409	6	510	428	7
504	441	7	511	407	6
505	408	6	512	424	7
506	428	7	513	408	6
507	408	6	515	392	6

Note: all sizes are approximate



Ready to talk?

We're a friendly bunch, so why not get in touch?

01429 239 500

hartlepool@ukse.co.uk

The Innovation Centre
Venture Court
Queens Meadow Business Park
Hartlepool TS25 5TG

Visit us online:

www.ukse.co.uk

ukse.